

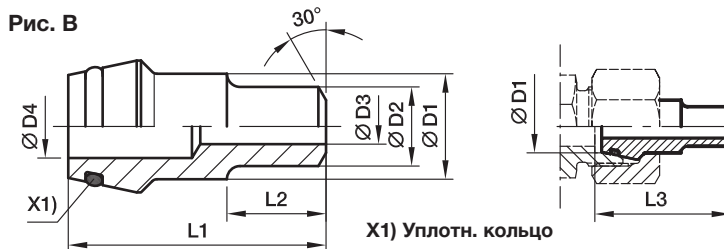

SKAR Сварной штуцер редуктор

EO 24° Фитинг с уплотн. кольцом / Стыковое сварное соединение

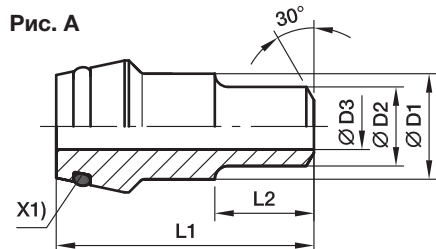

| Серия | D1 | D2 | D3 | D4 | L1 | L2 | L3 | Fig. | Вес г/шт. | Код заказа | PN (бар) ¹⁾ | |
|----------------------------------|----|----|----|------|------|------|------|------|-------------|---------------|------------------------|-------------|
| | | | | | | | | | | | Сталь | Нерж. Сталь |
| L ³ /S ⁴) | 08 | 06 | 3 | | 31,0 | 12 | 31,5 | A | 14 | SKAR08/06X1.5 | 528 | 539 |
| | 10 | 06 | 3 | 5 | 32,5 | 12 | 33,5 | B | 15 | SKAR10/06X1.5 | 528 | 539 |
| | 10 | 08 | 5 | | 32,5 | 12 | 33,5 | A | 16 | SKAR10/08X1.5 | 414 | 424 |
| | 10 | 08 | 4 | | 32,5 | 12 | 33,5 | A | 17 | SKAR10/08X2 | 528 | 539 |
| | 12 | 08 | 5 | | 32,5 | 14 | 33,5 | A | 18 | SKAR12/08X1.5 | 414 | 424 |
| | 12 | 08 | 4 | 6 | 32,5 | 14 | 33,5 | B | 20 | SKAR12/08X2 | 528 | 539 |
| | 12 | 10 | 7 | | 32,5 | 14 | 33,5 | A | 18 | SKAR12/10X1.5 | 358 | 349 |
| S ⁴) | 16 | 10 | 6 | | 39,0 | 15 | 40,5 | A | 43 | SKAR16/10X2 | 400 | 400 |
| | 16 | 12 | 9 | | 39,0 | 15 | 40,5 | A | 45 | SKAR16/12X1.5 | 305 | 297 |
| | 16 | 12 | 8 | | 39,0 | 15 | 40,5 | A | 47 | SKAR16/12X2 | 393 | 383 |
| | 16 | 12 | 7 | | 39,0 | 15 | 40,5 | A | 49 | SKAR16/12X2.5 | 400 | 400 |
| | 20 | 12 | 9 | | 45,0 | 17 | 47,0 | A | 76 | SKAR20/12X1.5 | 305 | 297 |
| | 20 | 12 | 8 | | 45,0 | 17 | 47,0 | A | 78 | SKAR20/12X2 | 393 | 383 |
| | 20 | 12 | 7 | | 45,0 | 17 | 47,0 | A | 80 | SKAR20/12X2.5 | 400 | 400 |
| | 20 | 12 | 6 | | 45,0 | 17 | 47,0 | A | 86 | SKAR20/12X3 | 400 | 400 |
| | 20 | 16 | 12 | | 45,0 | 17 | 47,0 | A | 74 | SKAR20/16X2 | 305 | 297 |
| | 20 | 16 | 11 | | 45,0 | 17 | 47,0 | A | 76 | SKAR20/16X2.5 | 372 | 362 |
| | 20 | 16 | 10 | | 45,0 | 17 | 47,0 | A | 78 | SKAR20/16X3 | 400 | 400 |
| | 25 | 12 | 9 | | 49,5 | 20 | 53,0 | A | 117 | SKAR25/12X1.5 | 305 | 297 |
| | 25 | 12 | 8 | | 49,5 | 20 | 53,0 | A | 121 | SKAR25/12X2 | 393 | 383 |
| | 25 | 12 | 7 | | 49,5 | 20 | 53,0 | A | 125 | SKAR25/12X2.5 | 400 | 400 |
| | 25 | 12 | 6 | 15 | 49,5 | 20 | 53,0 | B | 129 | SKAR25/12X3 | 400 | 400 |
| | 25 | 16 | 12 | | 49,5 | 20 | 53,0 | A | 115 | SKAR25/16X2 | 305 | 297 |
| | 25 | 16 | 11 | | 49,5 | 20 | 53,0 | A | 120 | SKAR25/16X2.5 | 372 | 362 |
| | 25 | 16 | 10 | | 49,5 | 20 | 53,0 | A | 123 | SKAR25/16X3 | 400 | 400 |
| | 25 | 20 | 16 | | 49,5 | 20 | 53,0 | A | 94 | SKAR25/20X2 | 249 | 242 |
| | 25 | 20 | 15 | | 49,5 | 20 | 53,0 | A | 104 | SKAR25/20X2.5 | 305 | 297 |
| | 25 | 20 | 14 | | 49,5 | 20 | 53,0 | A | 114 | SKAR25/20X3 | 358 | 349 |
| | 25 | 20 | 12 | | 49,5 | 20 | 53,0 | A | 124 | SKAR25/20X4 | 400 | 400 |
| | 30 | 12 | 9 | 22 | 52,0 | 22 | 57,0 | B | 135 | SKAR30/12X1.5 | 305 | 297 |
| | 30 | 12 | 8 | 22 | 52,0 | 22 | 57,0 | B | 145 | SKAR30/12X2 | 323 | 383 |
| | 30 | 12 | 6 | 22 | 52,0 | 22 | 57,0 | B | 155 | SKAR30/12X3 | 400 | 400 |
| | 30 | 16 | 12 | | 52,0 | 22 | 57,0 | A | 166 | SKAR30/16X2 | 305 | 297 |
| | 30 | 16 | 11 | | 52,0 | 22 | 57,0 | A | 176 | SKAR30/16X2.5 | 323 | 362 |
| | 30 | 20 | 16 | | 52,0 | 22 | 57,0 | A | 149 | SKAR30/20X2 | 249 | 242 |
| | 30 | 20 | 15 | | 52,0 | 22 | 57,0 | A | 159 | SKAR30/20X2.5 | 305 | 297 |
| | 30 | 20 | 14 | | 52,0 | 22 | 57,0 | A | 169 | SKAR30/20X3 | 358 | 349 |
| | 30 | 20 | 12 | | 52,0 | 22 | 57,0 | A | 184 | SKAR30/20X4 | 400 | 400 |
| | 30 | 25 | 20 | | 52,0 | 22 | 57,0 | A | 141 | SKAR30/25X2.5 | 249 | 242 |
| 30 | 25 | 19 | | 52,0 | 22 | 57,0 | A | 156 | SKAR30/25X3 | 294 | 286 | |
| 30 | 25 | 17 | | 52,0 | 22 | 57,0 | A | 168 | SKAR30/25X4 | 379 | 369 | |

SKAR Сварной штуцер редуктор

EO 24° Фитинг с уплотн. кольцом / Стыковое сварное соединение

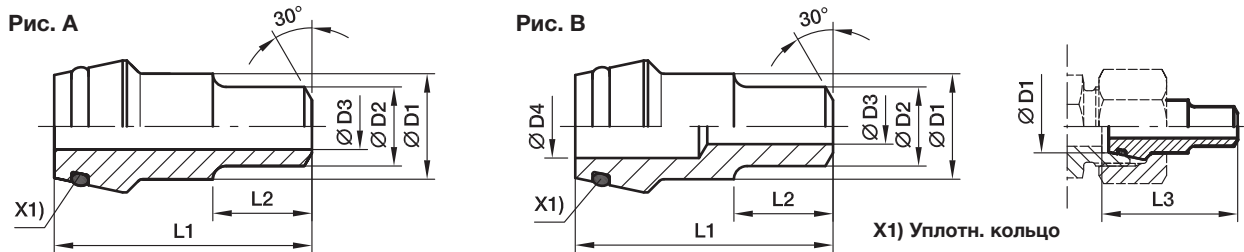

| Серия | D1 | D2 | D3 | D4 | L1 | L2 | L3 | Fig. | Вес г/шт. | Код заказа | PN (бар) ¹⁾ | |
|-----------------|----|----|----|----|------|----|------|------|--------------|----------------------|------------------------|----------------|
| | | | | | | | | | | | Сталь | Нерж. Сталь |
| S ⁴⁾ | 38 | 12 | 9 | 28 | 56,5 | 26 | 64,0 | B | 219 | SKAR38/12X1.5 | 305 | 297 |
| | 38 | 12 | 8 | 28 | 56,5 | 26 | 64,0 | B | 234 | SKAR38/12X2 | 315 | 315 |
| | 38 | 12 | 6 | 28 | 56,5 | 26 | 64,0 | B | 249 | SKAR38/12X3 | 315 | 315 |
| | 38 | 16 | 12 | | 56,5 | 26 | 64,0 | A | 279 | SKAR38/16X2 | 305 | 297 |
| | 38 | 16 | 11 | | 56,5 | 26 | 64,0 | A | 294 | SKAR38/16X2.5 | 315 | 315 |
| | 38 | 16 | 10 | | 56,5 | 26 | 64,0 | A | 309 | SKAR38/16X3 | 315 | 315 |
| | 38 | 20 | 16 | | 56,5 | 26 | 64,0 | A | 263 | SKAR38/20X2 | 249 | 242 |
| | 38 | 20 | 15 | | 56,5 | 26 | 64,0 | A | 278 | SKAR38/20X2.5 | 305 | 297 |
| | 38 | 20 | 14 | | 56,5 | 26 | 64,0 | A | 293 | SKAR38/20X3 | 315 | 315 |
| | 38 | 20 | 12 | | 56,5 | 26 | 64,0 | A | 299 | SKAR38/20X4 | 315 | 315 |
| | 38 | 25 | 20 | | 56,5 | 26 | 64,0 | A | 242 | SKAR38/25X2.5 | 249 | 242 |
| | 38 | 25 | 19 | | 56,5 | 26 | 64,0 | A | 262 | SKAR38/25X3 | 294 | 286 |
| | 38 | 25 | 17 | | 56,5 | 26 | 64,0 | B | 285 | SKAR38/25X4 | 315 | 315 |
| | 38 | 30 | 24 | | 56,5 | 26 | 64,0 | A | 256 | SKAR38/30X3 | 249 | 242 |
| | 38 | 30 | 22 | | 56,5 | 26 | 64,0 | A | 286 | SKAR38/30X4 | 315 | 315 |
| | 38 | 30 | 20 | | 56,5 | 26 | 64,0 | A | 316 | SKAR38/30X5 | 315 | 315 |

¹⁾ Давление указано = позиция может быть доставлена

³⁾ L = лёгкая серия; ⁴⁾ S = тяжёлая серия

$$\frac{PN \text{ (бар)}}{10} = PN \text{ (МПа)}$$

*Пожалуйста, добавьте приведенные **суффиксы** в соответствии с необходимым материалом/поверхностью.

| Суффиксы кода заказа | | | |
|----------------------|---------------------------------|---------------|--|
| Материал | Суффикс поверхности и материала | Пример | Стандартный материал уплотнителя (не треб. доп. суффикс) |
| Сталь | | SKAR16/12X2 | NBR |
| Нерж. сталь | 71 | SKAR16/12X271 | VIT |